

EFDM Series



Technical specification

Application:	In-line duplex filter
Ports:	G½", G¾", G1¼", G1½" & SAE DN40 3000 psi
Flow rate:	max. 400 l/min
Working pressure:	max. 210 bar
Burst pressure:	min. 630 bar
Element collapse pressure:	21 or 210 bar
By-pass opening pressure:	Δp 7 bar \pm 0.5 bar
Clogging indicator setting:	Δp 5 bar \pm 10%
Seals:	Perbunan (NBR, -10°C to 100°C)
Material:	EN-GJS-400-15 head & steel bowl
Compatibility:	Suitable for mineral oils, lubrication oils, non-flam fluids, synthetic and rapidly biodegradable oils (for use with water, please contact our technical dept.)
Tested according to ISO standards:	ISO2941 Collapse/burst resistance ISO2942 Fabrication integrity ISO2943 Material compatibility integrity ISO3723 Method for end load test ISO3724 Flow fatigue characteristics ISO3968 Pressure drop vs. Flow ISO16889 Multi-pass (filtration performance)

Technical specification subject to change without prior notice. Other specification on request. 2013/07/23

Pressure drop graphs (Δp)

Pressure drop of filter housing (mainly depending on port size)

EEDM2, EEDM3 & EEDM4

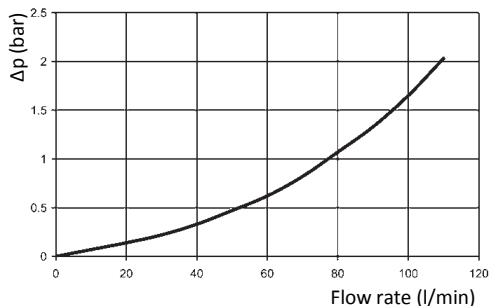

EEDM5, EEDM7 & EEDM10

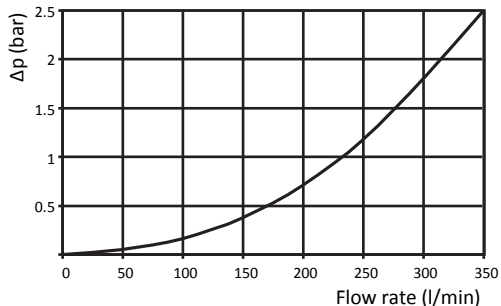

Pressure drop of clean filter elements (fibreglass filter media)

EEDM2

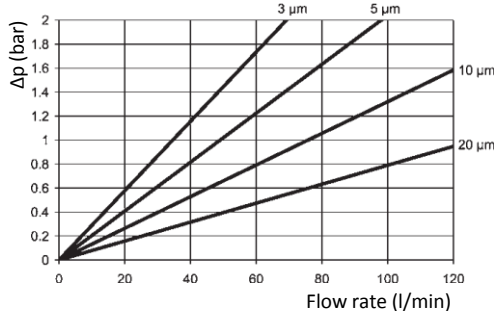

EEDM3

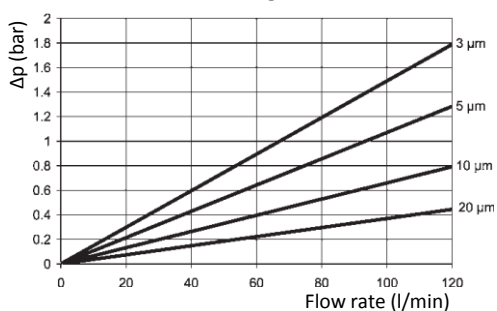

EEDM4

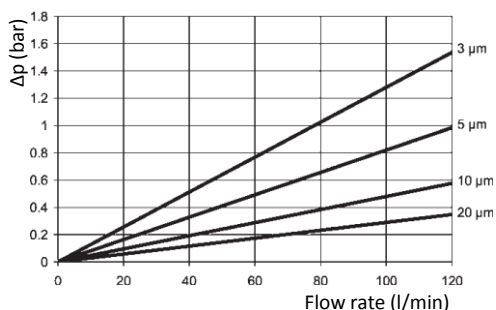

EEDM5

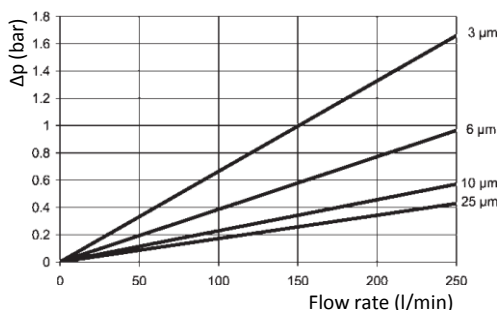

EEDM7

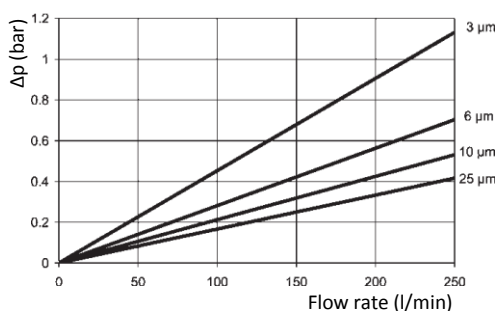

EEDM10

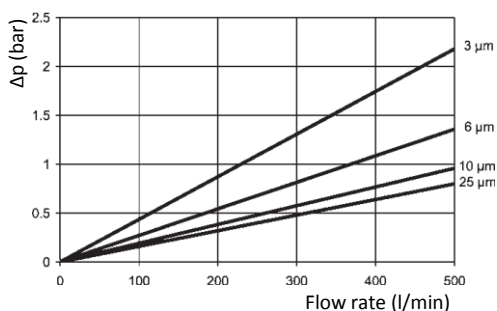

The test fluid has a density of 0.86 kg/dm³ and a kinematic viscosity of 30 mm²/s.

Dimensional drawings

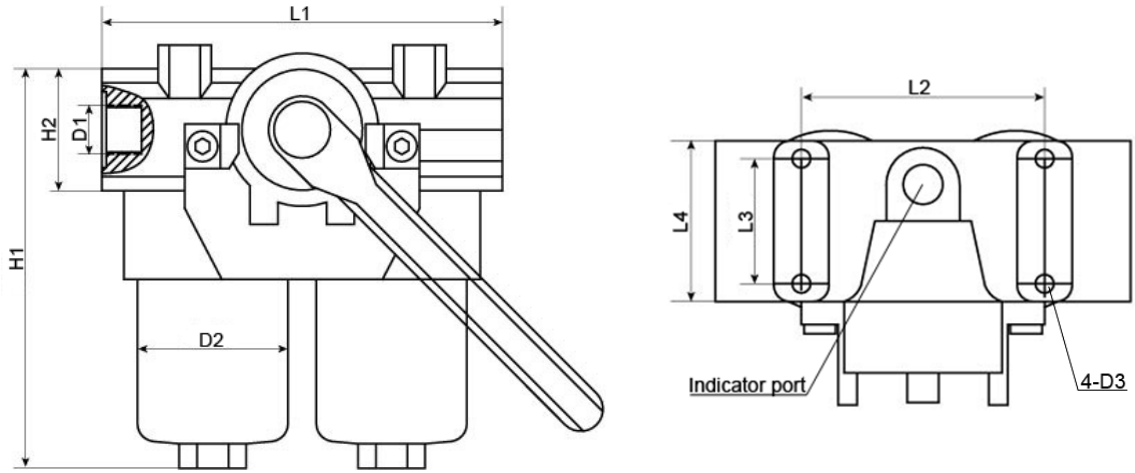

Type	D1	D2	D3	H1	H2	L1	L2	L3	L4
EFDM2	G 1/2"	68	M8x16	180	55	190	106	54.5	70
EFDM3	G 3/4"	68	M8x16	245	55	190	106	54.5	70
EFDM4	G 3/4"	68	M8x16	290	55	190	106	54.5	70
EFDM5	G 1 1/4"	94	M12x19	310	90	282	164	69.0	112
EFDM7	G 1 1/2"	94	M12x19	400	90	282	164	69.0	112
EFDM10	SAE DN40 3000 psi	94	M12x19	550	90	282	164	69.0	112

Technical specification subject to change without prior notice. Other specification on request. 2013/07/23

Order information

Filter assembly part number

Housing					Element	Accessories	
Type	Size	Connection	By-pass	Seal	Media	Indicator	Special
EFDM	Table 1	Table 2	Table 3	Table 4	Table 5	Table 6	X
Example EFDM	2	BB	12	B	M03	5PV	X

Element part number

Element			
Type	Size	Seal	Media
EEDM	Table 1	Table 4	Table 5
Example EEDM	2	B	M03

Tables

Table 1	
EVO size	Flow rate (l/min)
EFDM2	60
EFDM3	110
EFDM4	140
EFDM5	160
EFDM7	250
EFDM10	400

Table 2					Size
Connection					
BB	BC	BE	BF	FE	SAE DN40 3000 psi
G1/2"	G3/4"	G1 1/4"	G1 1/2"		
•					EFDM2
	•				EFDM3
	•				EFDM4
		•			EFDM5
			•		EFDM7
				•	EFDM10

Table 3	
By-pass	Open pressure
00	No by-pass
12	7 bar
X	Special

Table 4	
Seal	Material
B	Buna
V	Viton

Table 5			
Media	Material	Filtration	Collapse
M03	Fibreglass	3 µm	21 bar
M05	Fibreglass	5 µm	21 bar
M10	Fibreglass	10 µm	21 bar
M20	Fibreglass	20 µm	21 bar
H03	Fibreglass	3 µm	210 bar
H05	Fibreglass	5 µm	210 bar
H10	Fibreglass	10 µm	210 bar
H20	Fibreglass	20 µm	210 bar
Y25	Wire mesh	25 µm	21 bar
Y60	Wire mesh	60 µm	21 bar
Y90	Wire mesh	90 µm	21 bar
Y125	Wire mesh	125 µm	21 bar

Table 5		
Indicator	Pressure	Type
00	-	No gauge
5PV	5 bar	Visual
5PE	5 bar	Electrical
5PB	5 bar	Visual / Electrical

Technical specification subject to change without prior notice. Other specification on request. 2013/07/23